

FR1 SERIES

FRT SERIES

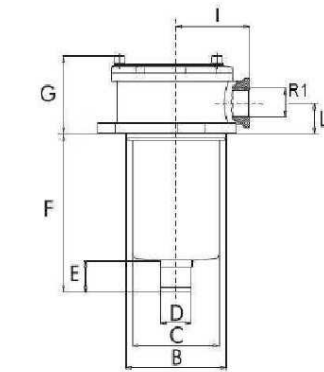

FRT-R1-10/20/22/30
FR1-10 / 20 / 21 / 22 / 23

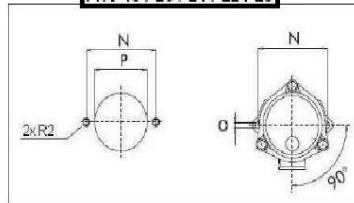

FRT-R1-40/41
FR1-40 / 41

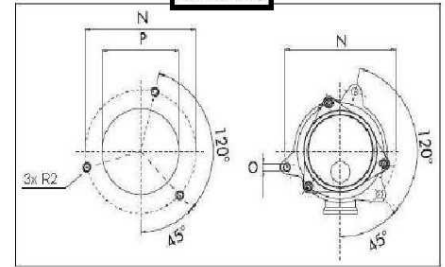

FRT-R1-50/51/60/64/66
FR1-50 / 51 / 52 / 60 / 61 / 64

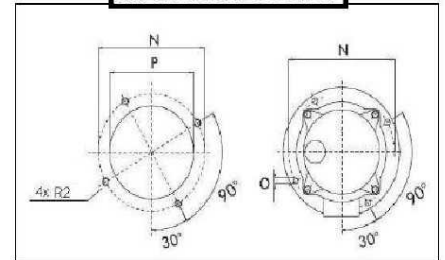

Part n°	R1	R2	Size	Cartridge	ØB	ØC	ØD	ØP	E	F	G	I	L	N	O
FR1-20	1/2" BSP	M8	20	R-1-20	87,5	80	27,5	88,5	27	106	73	67	28,5	115	8,5
FR1-61	2" BSP	M10	61	R-1-60	174	151	64	175	41	238	108	119	41	220	11
FRT-R1-10	1/2" BSP	M6	10	R-1-10	67		24	67,5		82	60	51	28.5	89	
FRT-R1-20	1/2" BSP	M8	20	R-1-20	87		40	88,5		92	73	67	28.5	115	
FRT-R1-22	3/4" BSP	M8	22	R-1-22	87		40	88.5		137	73	67	28.5	115	
FRT-R1-30	1" BSP	M8	30	R-1-30	87		40	88,5		218	73	67	28.5	115	
FRT-R1-40	1" BSP	M10	40	R-1-40	129		40	130		223	90	95	35	175	
FRT-R1-41	1"1/4 BSP	M10	40	R-1-40	129		40	130	-	223	90	95	35	175	
FRT-R1-45	1"1/2 BSP	M10	45	R-1-45	129		40	130		436	90	95	35	175	
FRT-R1-50	1"1/4 BSP	M10	50	R-1-50	174		65	175		164	90	115	42	220	
FRT-R1-51	1"1/2 BSP	M10	51	R-1-61	174		65	175		223	105	115	42	220	
FRT-R1-60	1"1/2 BSP	M10	60	R-1-60	174		65	175		223	105	115	42	220	
FRT-R1-64	2" BSP	M10	64	R-1-64	174		65	175		273	105	115	42	220	
FRT-R1-66	2" BSP	M10	66	R-1-66	174		65	175		423	105	115	42	220	

*** Review attached PDF***