

Coupling for variable displacement pumps

ACOP...0101



BPCV71DFR0101

▼ Splined shaft 1 1/4 in (SAE J744)

S - 14T 12/24DP²⁾

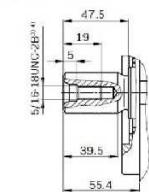

BPCV45DFR0101

▼ Splined shaft 1 in (SAE J744)

S - 15T 16/32DP¹⁾

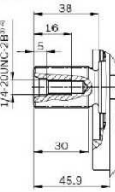

BPCV28DFR0101

▼ Splined shaft 7/8 in (SAE J744)

S - 13T 16/32DP¹⁾

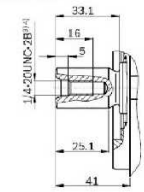

ACOP...0202



BPCV71DFR0202

▼ Eje cilíndrico con chaveta (DIN 6885)

P - A10 x 8 x 45

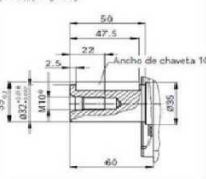

BPCV45DFR0202

▼ Eje cilíndrico con chaveta (DIN 6885)

P - A8 x 7 x 35

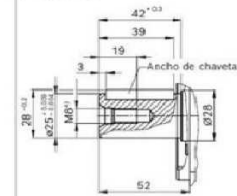

BPCV28DFR0202

▼ Eje cilíndrico con chaveta (DIN 6885)

P - A6 x 6 x 32

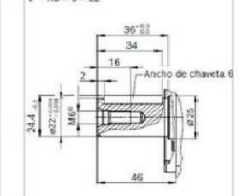

Part nº	Spiders	Motor side	Pump side	POWER (HP)
ACOP28010125CV	POL-5*	55 mm Cil.	22.22 mm Z13	25
ACOP28020225CV	R103*	55 mm Cil	22 mm Cil	25
ACOP45010140CV	POL-6*	60 mm Cil	25.4 mm Z15	40
ACOP45020240CV	R103*	60 mm Cil	25 mm Cil.	40
ACOP71010150CV	POL-6*	65 mm Cil	31.75 mm Z14	50
ACOP71020250CV	R132*	65 mm Cil.	32 mm Cil	50

*Check availability